

**DUSTRACTION**  
*Limited*



MADE IN THE UK

1100M<sup>3</sup>/hr Extraction Capacity

Three Stage Filtration:

Aluminium Mesh Filter

Pre-filter

High Efficiency Particulate Arrestor (HEPA) Filter

68dB Maximum Noise Level

Supports CoSHH & HSG 258 Guidance  
Document on Air Recirculation

Available in 110, 240 & 400 volt

**INTRODUCING THE NEW DUSTRAX PRO**

# Dust & Fume Extraction

Founded in 1995, Dustraction Ltd is a leading UK independent manufacturer of quality Dust Extraction and Dust Control equipment.

Dust and fume extraction are a main requirement of most manufacturing industries. Our dust extraction units can remove particles from the workplace for a wide range of materials such as wood, metal, chemicals and composites. Our bespoke units range from stand alone dust extraction systems for one machine, to larger, centralised dust control systems. Our Leicester factory has a manufacturing area of over 10,000 square feet and is equipped with modern machinery, including CNC plasma profiling and CNC press brakes.

*Manufacturer of quality Dust Extraction  
and Dust Control equipment*

## Dust & Fume: Health & Safety Requirements

The generation of dust or fume from a given process can often be unavoidable. When this is the case it is essential that employers utilise a Local Exhaust Ventilation (LEV) that is designed, installed and tested to ensure full compliance with the Control of Substances Hazardous to Health (CoSHH) and the Health and Safety Executive (HSE) guidance set out in HSG 258 - Controlling Airborne Contaminants at Work: A guide to local exhaust ventilation.

Under CoSHH, employers have a legal duty to ensure that employees are protected against harmful effects of exposure to dust and fume.

Flextraction fully endorses and adopts the framework of HSG 258 and can offer our customers a solution that supports the employer's legal obligations thereby helping protect the employee.

Based on scientific evidence from the International Agency for Research on Cancer (IARC) exposure to welding fume, including **mild steel welding fume can cause lung cancer** and possibly kidney cancer in humans. As a result, the Workplace Health Expert Committee has endorsed the **reclassification of mild steel welding fume as a human carcinogen**.

## Other Services

Dustraction are also able to supply and install and commission full turnkey projects, carry out performance evaluation of existing systems and to complete LEV, emission and noise testing services throughout the UK using our team of engineers.

Call **(0116) 271 3212** today for your free consultation



# Mobile Filter Unit

Introducing the **Dustrax Pro** Mobile Filter Unit from Dustraction Ltd.

Designed specifically to meet the needs of the Welding Industry, the mobile filter unit comes with a 2.5m swivel mounted extraction arm. The swivel mounting enables a full 360-degree rotation of the extraction arm.

Designed for single welder operation the unit is fully mobile and coupled with the 360 rotating arm, allows the Dustrax PRO to be easily positioned, giving excellent flexibility in the workplace. Once in place the wheels can be locked to ensure safety and stability. Available to suit 3 different supply voltages, the unit is supplied with a 3m flying lead for easy connection.

To ensure that the **Dustrax Pro** provides adequate extraction at all times a warning light and audible alarm are fitted to alert the user to the fact the filters are becoming saturated and require replacement.

With no tools required to change the filters, maintenance is simple and straight forward.



**DUSTRACTION**  
*Limited*

# Welding: Targeted

The mobile units are suitable for welding applications of:

- Manual welding
- MIG/MAG/TIG welding
- Gas welding

The Dustrax Pro mobile filtration unit is capable of being up and running in a matter of minutes. It arrives only requiring the extraction arm to be attached to the unit by means of three fixings; plug into the power supply, position the arm and it is ready to go.

**The units are designed and manufactured in the UK.**

The unit and extraction arm are supplied FULLY assembled; and there are NO internal components within the arm

It supports CoSHH and the HSG258 Guidance document on air recirculation

NO complicated electrics and control elements

Loaded particle filter indicator and alarm

Four castors - with brakes on front two

Simple filter handling

Modular design for ease of cleaning

Powder coated, rugged steel housing

Backward curved mild steel impeller



## Technical Specification

Sound Level (@1m)	Motor	Power Supply	Suction Capacity	Arm Diameter	Filtration Filter Efficiency	Max Dimensions	Total Weight (Unit)
dB(A)	kW	110/240 / 400 v	m <sup>3</sup> /h	mm	% <sup>2</sup>	mm	Kg
68	1.1	14.04A 7.04A 1.79A	1100	160	99.95	702 x 746 x 1060	134



# Filtration: 3 Stages

The mobile units come with three stages of filtration comprising of:

- Aluminium Mesh Filter
- Pre-filter
- High Efficiency Particulate Arrestor (HEPA) Filter

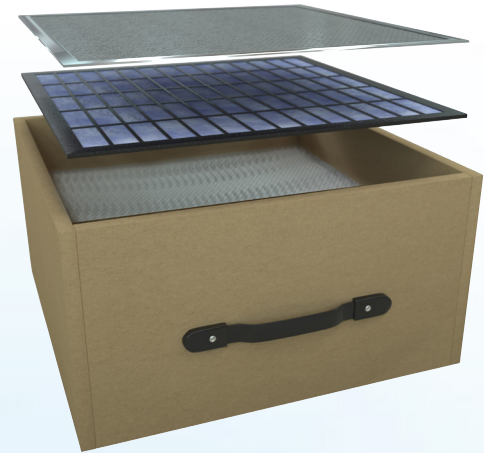

The 3-stage filtration process aims to progressively filter the harmful particles from the contaminated air stream as the air passes through the Dustrax Pro.

The use of an aluminium mesh at stage one reduces the possibility of sparks passing through.

The second stage Pre-filter removes the majority of particles before the air finally passes through the third stage which captures 99.95% of the particles prior to exhausting very high level of cleaned air back into the work place.

The filters are non-cleanable, when they become saturated a warning light and alarm are triggered alerting the user that control of exposure may be inadequate and action should be taken.



# Housekeeping: Industrial Vacuums

Good housekeeping is essential across all industries and to complement our range of mobile filter units, extraction arms and downflow booths, we offer a comprehensive range of industrial vacuums to suit a multitude of applications and processes.



There are a wide range of applications that benefit from the use of industrial vacuum cleaners. The provision of vacuum suction systems, be it a centralised or standalone unit, can go a long way in ensuring the workplace is maintained in good order, benefiting to the health and safety of all.

Our range of industrial vacuums can be customized to meet your needs and made with options in line with safety standards, meeting:

- Total or partial construction in stainless steel AISI304-316
- Filtration certified at European level (L-M-H) and specific for different applications (antistatic filters, absolute filters, NOMEX filters (for high temperature material, up to 250°)
- Certified industrial vacuum cleaners for areas with risk of explosion ATEX zones 1, 2, 21, 22
- Use of pre-separators or hoppers to facilitate collection and handling of fine powders or aspirated material
- Specific accessories for use in food industry (silicone accessories, certified hoses for use in food industry)

With our experience across all industries, we know that utilising industrial vacuum units offer a solution that ensures increased efficiency and workplace safety with considerable advantages for production cycles.

Contact us for free advice on how to identify the best extraction solution for your production area.



# Design: Installation & Testing

Our design team are conscious of, and committed to meeting, the requirements of the Health & Safety Executive's guidance document HSG258. HSG258 outlines the procedures and processes that are required in controlling airborne contaminants in the workplace.

Our in-house team of installers give the same 100% no matter how large or how small the job; be that the installation of a single extraction arm, through to the installation of a fully centralised dust or fume extraction system.

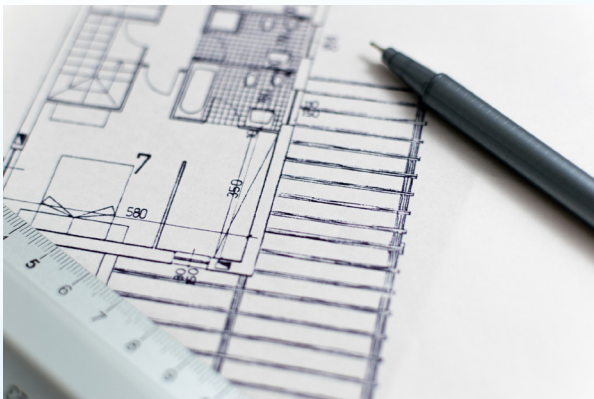
A screenshot of a 'Extraction Unit Test Report' form. The form is titled 'Extraction Unit Test Report' and includes the following sections:

- Control of Substances Hazardous to Health (COSHH) Regulations 2002**
- Report on periodic thorough examination and test**
- PART 2**
- General Information**: Name of Plant, Department, Contact Name, Date, Process Description.
- Place/Installation/Unit**: A table with columns for 'Place/Installation/Unit', 'Inspected', 'Tested', and 'Status'. It lists various components like '1) Fan', '2) Motor', '3) Filter', etc.
- Details of changes**: A section for recording any changes made during the inspection.
- Inspector's Details**: Name, Signature, Designation, Date.
- Overall Status**: A dropdown menu showing 'Satisfactory (see comments)'. There is also a 'Not Satisfactory' option.
- Verification required**: A section for recording any verification required, with fields for 'Required', 'Inspected', and 'Date of next inspection'.

We commission and test systems and offer a full testing service in line with the Control of Substances Hazardous to Health (CoSHH) Regulations 2002.

All tests are supported with a comprehensive written report that incorporates a system diagram, along with the findings and recommendations of the testing engineer.



**5 YEAR WARRANTY**

## Warranty: 1 to 5 Years...

The unit and extraction arm are offered with a 12 month warranty. However, additional to the arm that is supplied with the mobile extraction unit, we have a range of extraction arms that have been provided to industry for over 21 years. Their success has been well proven and their track record, design and engineering excellence has enabled us to offer them with a 5 year warranty.

To take advantage of this, customers simply have to complete and return the registration card that is supplied with each extraction arm (excludes hose and failure due to misuse).

Provider of bespoke solutions for all  
your dust containment requirements

**Dustraction Limited**  
**1 Pomeroy Drive**  
**Oadby Industrial Estate**  
**Oadby**  
**Leicester, LE2 5NE**

**0116 271 3212**

